



Seat arrangement(FRT)



Seat arrangement(RR)

## INTERIOR



Tilt & Telescopic steering wheel



Middle safety mirror



Entrance separator with screen

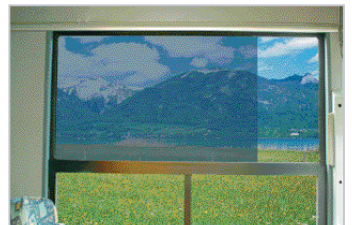

Driver solar screen



Wheel chair space



Gradual parking brake



Air conditioner louver (option)



Driver separator - Partition type (option)

# POWER

## GE12TI, CNG

Displacement : 11,051cc  
 Max horse power : 290ps/2,200rpm  
 Max torque : 115kg.m/1,320rpm

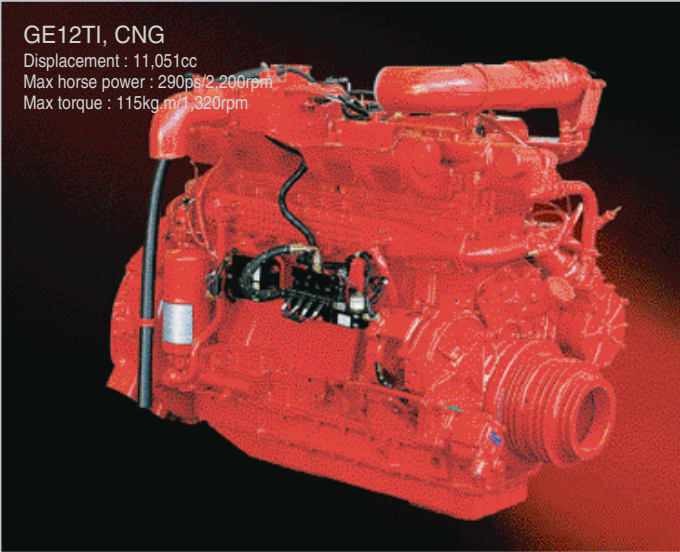

Engine

## DL 08, DIESEL(EURO III)

Displacement : 7,640cc  
 Max horse power : 300ps/2,200rpm  
 Max torque : 115kg.m/1,200rpm



Engine (option)

# TRANSMISSION

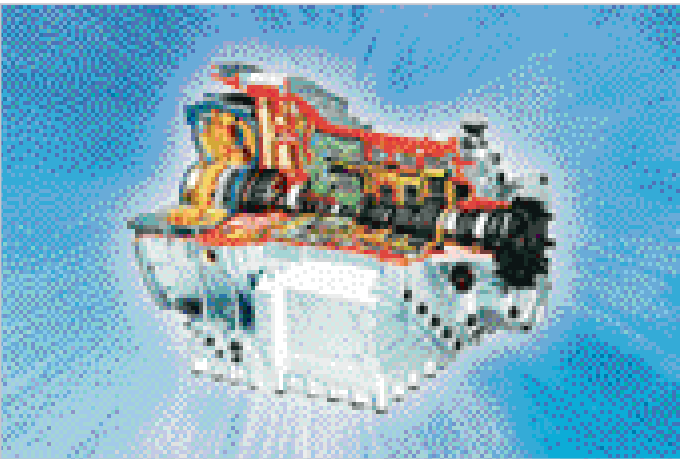

Auto transmission

# SUSPENSION

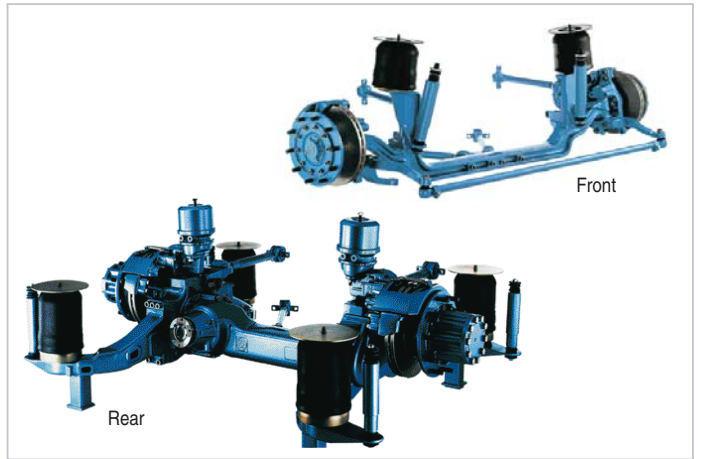

FRT/RR wide air suspension

# EXTERIOR



Kneeling system with switch (option)

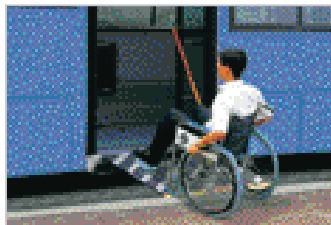

Wheel chair ramp (option)



Comfortable entrance step

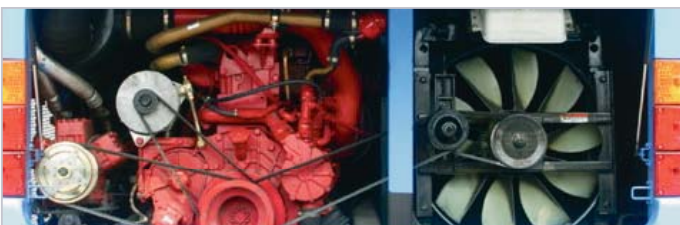

Engine room



Destination board-dot type (option)



CNG injection receptacle

# BC211CN / BC212CN STANDARD SPECIFICATION

## BC211CN

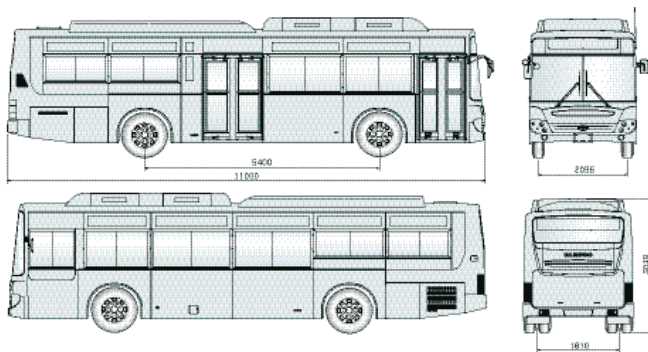

28+1

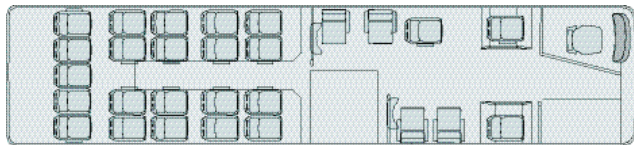

## BC212CN

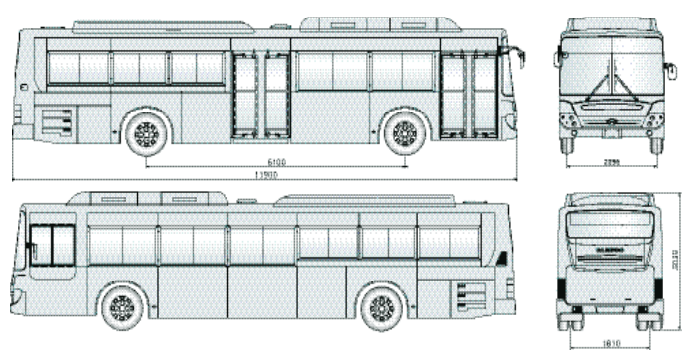

30 +1

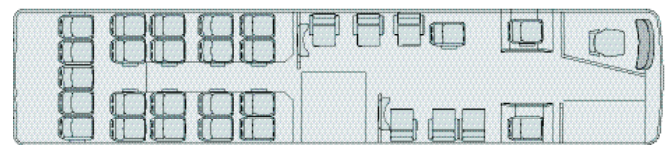

### Major Specifications

BODY STRUCTURE	RIVETLESS SKELETON, STEEL BODY
HANDLE POSITION	LEFT HAND DRIVE
ENGINE MOUNTING	REAR
PASSENGER CAPACITY	BC211CN : 28(+46)+1 PERSONS BC212CN : 30(+50)+1 PERSONS

### External Dimensions (mm)

	BC211CN	BC212CN
OVERALL LENGTH	11,000	11,900
OVERALL WIDTH	2,500	2,500
OVERALL HEIGHT	3,039	3,039
WHEEL BASE	5,400	6,100
BODY OVERHANG (FRONT)	2,440	2,640
BODY OVERHANG (REAR)	3,160	3,160
TREAD (FRONT)	2,096	2,096
TREAD (REAR)	1,810	1,810

### Internal Dimensions (mm)

	BC211CN	BC212CN
INSIDE LENGTH	10,270	11,170
INSIDE WIDTH	2,380	2,380
INSIDE HEIGHT	2,340	2,340

### Weight (kg)

	BC211CN	BC212CN
PERMISSIBLE G.V.W	21,500	21,500
CURB WEIGHT	11,100	11,500
G.V.W	15,975	16,765

### Performance

	BC211CN	BC212CN
MAX SPEED	92km/h	92km/h
MIN TURNING RADIUS	10.4m	11.7m
GRADEABILITY(TAN $\theta$ )	0.48	0.45

### Frame

RECTANGULAR SECTION STEEL TUBE

### Engine

MODEL	GE12TI, CNG
TYPE	4 CYCLE, WATER COOLED
NO. OF CYLINDER	6, IN-LINE
BORE & STROKE	123 x 155mm
DISPLACEMENT	11.051cc
MAX HORSE POWER	290ps/2,200rpm
MAX TORQUE	115kg.m/1,320rpm
COMPRESSION RATIO	10.5 : 1
AIR CLEANER	DRY SINGLE PAPER ELEMENT

### Transmission : Auto

GEAR BOX	4 FORWARD & 1 REVERSE				
	1st	2nd	3rd	4th	REV.
	3.49	1.86	1.41	1.000	5.03

### Suspension

AIR SPRING(FRT/RR WIDE)  
DOUBLE ACTING SHOCK ABSORBER  
STABILIZER BAR

### Wheel & Tire

TIRE 275/70R22.5 TUBELESS TYPE  
WHEEL 8.25 x 22.5/10STUDS

### Steering

OPERATION RECIRCULATED BALL WITH INTEGRAL  
POWER ASSISTED BY OIL  
GEAR RATIO 22.4 : 1  
STEERING COLUMN TILT & TELESCOPIC  
STEERING WHEEL 2 SPOKE WHEEL WITH HORN BUTTON

### Air Service

AIR PRESSURE 9.0kg/cm<sup>2</sup>  
AIR TANK CAPACITY FRONT 25L, PARKING 35L  
REAR 35L, AUX. 25L  
AIR TAP FOR TIRE INFLATION  
AIR DRYER

### Brake

SERVICE BRAKE FULL AIR DUAL CIRCUIT BRAKE SYSTEM  
WITH 4 WAY PROTECTION VALVE  
FRONT DISC TYPE  
REAR DISC TYPE  
LINING MATERIAL NON-ASBESTOS  
PARKING BRAKE SPRING ACTUATOR AT REAR WHEEL  
WITH GRADUAL PARKING VALVE  
AUTO SLACK ADJUSTER

### Axle

FRONT AXLE  
TYPE CENTER DROP REVERSE ELLIOT 'I' BEAM  
CAPACITY 8,500kg  
REAR AXLE  
TYPE CENTER DROP AND DOUBLE REDUTION  
CAPACITY 13,000kg  
FINAL GEAR RATIO 4.18 HYPOID

### Fuel Tank

GAS CYLINDER-726L

### Horn

ELECTRIC TYPE

### Wiper Arm & Motor

STEEL, VARIABLE SPEED (TIME DELAY RELAY)

# BC211CN / BC212CN STANDARD SPECIFICATION

## Electrical

BATTERY	12V DC/MF-200AH 2PIECE
ALTERNATOR	24V DC/180AMP
STARTER	24V DC/6.0KW

## Meter & Gauge

TACHOGRAPH (ELECTRICAL WITHOUT RPM GAUGE)
AIR PRESSURE GAUGE
FUEL GAUGE
VOLTMETER
TACHOMETER
WATER TEMPERATURE GAUGE
ENGINE OIL PRESSURE GAUGE

## Glass

WINDSHIELD	3 SECTION LAMINATED UPPER TINTED
SIDE WINDOW	LARGE HALF OPENING TYPE TEMPERED GREEN
REAR WINDOW	1 SECTION FIXED TYPE TEMPERED GREEN
DRIVE WINDOW	SLIDING TYPE TEMPERED GREEN

## Seat

DRIVER SEAT	
TYPE	AIR SUSPENSION TYPE
UPHOLSTERY	CLOTH COVERING
SAFETY BELT	3 POINT WITH ALARM
PASSENGER SEAT	
TYPE	FIXED TYPE
UPHOLSTERY	CLOTH COVERING

## Door

ENTRANCE DOOR	FRONT / MIDDLE
TYPE	2 SECTION INWARD GLIDING DOOR
OPERATING	ELECTRICALLY CONTROLLED WITH AIR ASSIST

## Entrance Step

NUMBER OF STEP	NON STEP
MOULDING	YELLOW STRIP

## Floor

18mm THICKNESS PLYWOOD PLATE  
COVERED WITH TARAFLEX MAT (3.0mm, GREEN)

## Audio

STEREO W/O ECHO TYPE	AM / FM RADIO, CASSETTE STEREO, 9 SPEAKERS
ANTENNA	SIDE ANTENNA
STICK MIC & JACK	

## Interior Equipments

DEFROSTER	HOT/FRESH AIR
STOP BUTTON BUZZER	SIDE, ABOVE MID DOOR
DESTINATION PLATE	ACRYL TYPE
DRIVER SEPARATOR	P.V.C COATING PIPE W/SCREEN
ENTRANCE SEPARATOR	P.V.C COATING PIPE W/SCREEN
ENTRANCE DOOR HANDLE	P.V.C COATING PIPE
CEILING HANDLE	P.V.C COATING PIPE W/BELT

## Accessories

BUMPER (FRONT & REAR)	STEEL
OUTSIDE REAR VIEW MIRROR	CONVEX MIRROR
TOWING HOOK	FRONT & REAR
FIRE EXTINGUISHER	ABC TYPE (3.3kg)
SUNSHADE	ACRYL TYPE-LH
BATTERY STORAGE	STEEL COMPARTMENT W/SLIDING
VENTILATOR	LARGE MANUAL HATCH ON ROOF
EMERGENCY HAMMER	5EA
TOOL SET	

# BC211CN / BC212CN OPTION SPECIFICATION

## Options

- ENGINE**
- DE12TIS (290ps/115kgf.m, EURO II )
  - DL08 (300ps/115kgf.m, EURO III )

- CHASSIS**
- Automatic drain valve
  - Coolant corrosion inhibitor filter
  - Air pressure check tap
  - ABS & ASR
  - Auto greaser
  - Heavy duty radiator (without fan clutch)
  - Twin air horn
  - Dual air cleaner filter element
  - Gas cylinder - 847L
  - Kneeling system

- SEAT**
- Passenger seat - Leather covering

- TRIM**
- 2 section upper tinted windshield
  - Full opening type side window
  - Upper half opening side window
  - Rear window-Steel plate
  - Destination board - LED type
  - Destination board - Dot type
  - First aid box
  - Emergency escape ventilator
  - Drive barrier - Partition type

- HVAC**
- Roof on cooler (24,000/26,000 kcal/h)
  - Roof on cooler (28,000/30,000 kcal/h)
  - Passenger heater

- ELECTRICAL**
- Analog clock
  - Digital clock
  - Ramp for wheel chair-at middle door
  - Carvision (rear view camera)
  - Stereo with echo type
  - Tachograph (with RPM)



▪ EXPORTER

**DAEWOO BUS GLOBAL CORPORATION**

202-1,Ojung-dong, Ojung-gu, Bucheon, Gyeonggi-do, Korea  
Tel:82-32-680-6611~27 Fax:82-32-680-6610  
<http://global.daewoobus.com>

▪ MANUFACTURER

**DAEWOO BUS CORPORATION**

188-9,Jeonpo-dong, Busan Jin-gu, Busan, Korea  
Tel:82-51-811-4210, 520-5166~9 Fax:82-51-811-4055, 520-5147  
<http://www.daewoobus.co.kr>





**BC211CN / BC212CN**